



COR 70 HIDDEN SASH - HALF-HIDDEN SOLUTION

TBB

ENERGY EFFICIENCY

Thermal Transmission Coefficient

$U_w \geq 0.84$ (W/m²K)

Please consult typology, dimensions and glazing.

ACCOUSTIC INSULATION

Maximum glazing: 2.17"

Maximum acoustic insulation: $R_w = 44$ dB

CATEGORIES ACHIEVED AT TEST CENTRE

Protection against atmospheric agents

Air permeability (EN 12207):

Class 4

Water tightness (EN 12208):

Class E1800

Wind resistance (EN 12210):

Class C5

Reference test 48.43" x 58.27" / 2 sashes

SECTIONS	Frame 2.76" Sash 3.07"
PROFILE THICKNESS	Window 0.059"
MAXIMUM DIMENSIONS	Width (L) = 39.37" Height (H) = 66.93"
MAXIMUM WEIGHT/SASH	160 Kg
Please consult maximum dimensions according to types.	
FINISHES	Colour powder coating (RAL, mottled, rough...) According to Qualicoat >60 microns
	Wood effect powder coating According to Qualideco standard
	Anodized According to Ewwa Euras Standard Class 15
	Optionally Class 20 and 25 Optionally bicoloured

EXTRUSION ALLOY	6063 T-5
POLYAMIDE STRIP LENGTH	Polyamide 6.6 reinforced with 25% fiberglass: 1.26"-1.38"
GASKETS	EPDM triple gasket
FOAMS	Perimeter polyolefin foam in glazing rebate zone
OPENING POSSIBILITIES	INWARD Side hung, tilt, parallel sliding and turn&tilt
CERTIFICATES	DTA certification from CSTB lab.  Certification - 3204 

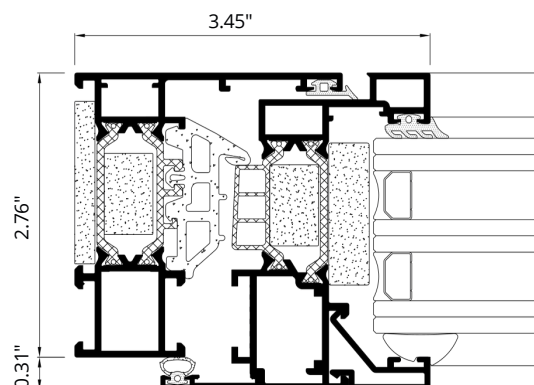



COR 70 HIDDEN SASH

TBB

ENERGY EFFICIENCY

Thermal Transmission Coefficient

$U_w \geq 0.85$ (W/m²K)

Please consult typology, dimensions and glazing.

ACCOUSTIC INSULATION

Maximum glazing: 1.57"

Maximum acoustic insulation: $R_w = 46$ dB

CATEGORIES ACHIEVED AT TEST CENTRE

Protection against atmospheric agents

Air permeability (EN 12207):

Class 4

Water tightness (EN 12208):

Class E1650

Wind resistance (EN 12210):

Class C5

Reference test 48.43" x 58.27" / 1 Sash

Passed

Security Test: **PAS24**

Reference test 43.31" x 94.49" / 1 sash

SECTIONS	Frame 2.76" Sash 2.76"
PROFILE THICKNESS	Window 0.075"
MAXIMUM DIMENSIONS	Standard solution Width (L) = 51.18" Height (H) = 94.49" HD Hinges (side hung) Width (L) = 47.24" Height (H) = 137.80"
MAXIMUM WEIGHT/SASH	160 Kg

Please consult maximum dimensions according to types.

FINISHES	Colour powder coating (RAL, mottled, rough...) According to Qualicoat >60 microns Wood effect powder coating According to Qualideco standard Anodized According to Ewwa Euras Standard Class 15 Optionally Class 20 and 25 Optionally bicoloured
----------	--

EXTRUSION ALLOY	6063 T-5
-----------------	----------

POLYAMIDE STRIP LENGTH	Polyamide 6.6 reinforced with 25% fiberglass: 1.38"
------------------------	--

GASKETS	EPDM triple gasket
---------	--------------------

FOAMS	Perimeter polyolefin foam in glazing rebate zone
-------	--

OPENING POSSIBILITIES	
INWARD	Side hung, tilt, parallel sliding and turn&tilt

CERTIFICATES	
DTA certification from CSTB lab.	
Certification - 3204	

